

THERMALLY BROKEN SUBFRAME
 SOFFIT FACE DETAIL

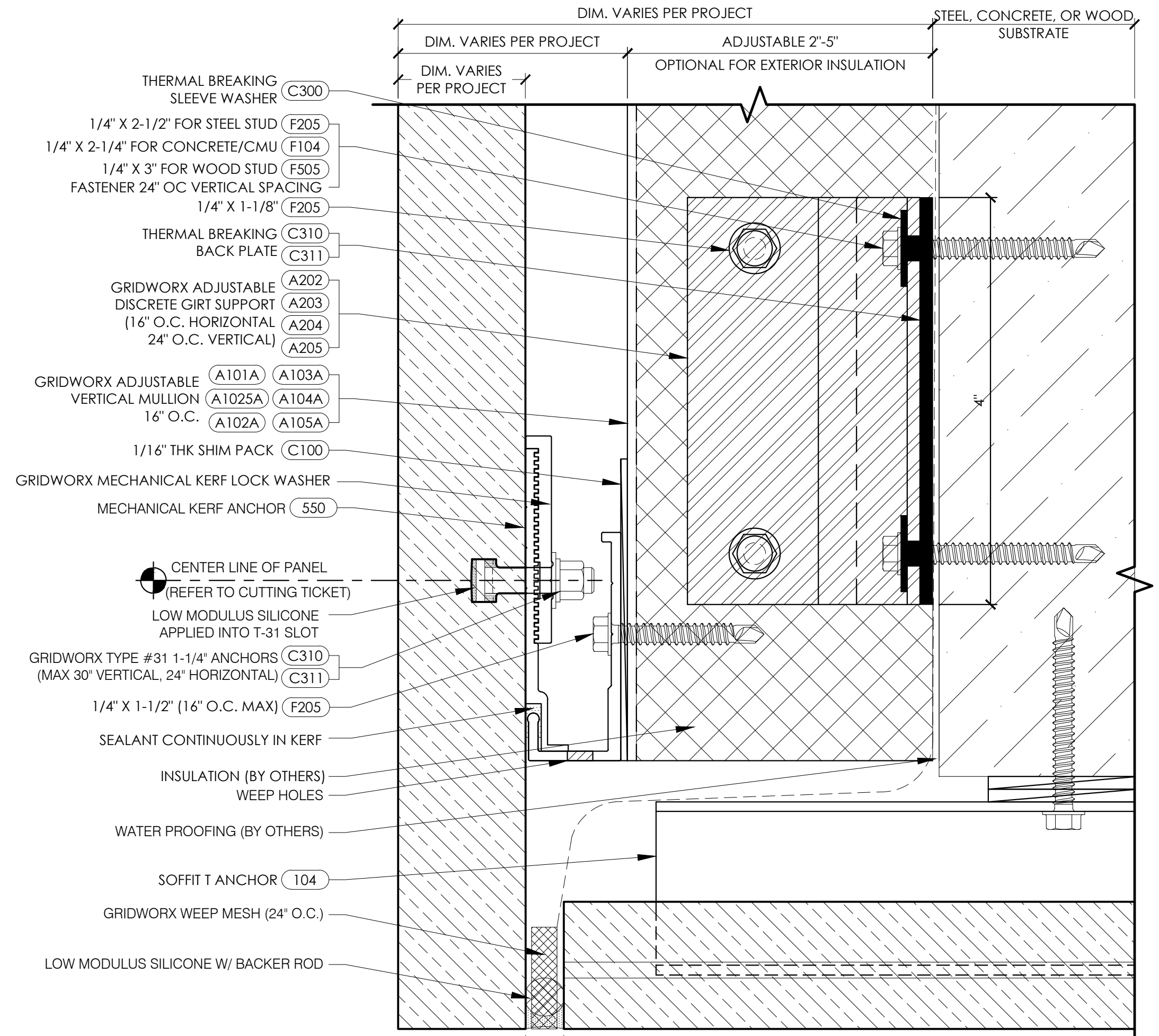

- THERMAL BREAKING SLEEVE WASHER (C300)
- 1/4" X 2-1/2" FOR STEEL STUD (F205)
- 1/4" X 2-1/4" FOR CONCRETE/CMU (F104)
- 1/4" X 3" FOR WOOD STUD (F505)
- FASTENER 24" OC VERTICAL SPACING
- 1/4" X 1-1/8" (F205)
- THERMAL BREAKING BACK PLATE (C310)
- (C311)
- GRIDWORX ADJUSTABLE DISCRETE GIRT SUPPORT (A202)
- (A203)
- (16" O.C. HORIZONTAL (A204)
- 24" O.C. VERTICAL) (A205)
- GRIDWORX ADJUSTABLE VERTICAL MULLION (A101A) (A103A)
- (A1025A) (A104A)
- 16" O.C. (A102A) (A105A)
- 1/16" THK SHIM PACK (C100)
- GRIDWORX MECHANICAL KERF LOCK WASHER
- MECHANICAL KERF ANCHOR (550)
- CENTER LINE OF PANEL (REFER TO CUTTING TICKET)
- LOW MODULUS SILICONE APPLIED INTO T-31 SLOT
- GRIDWORX TYPE #31 1-1/4" ANCHORS (C310)
- (MAX 30" VERTICAL, 24" HORIZONTAL) (C311)
- 1/4" X 1-1/2" (16" O.C. MAX) (F205)
- SEALANT CONTINUOUSLY IN KERF
- INSULATION (BY OTHERS)
- WEEP HOLES
- WATER PROOFING (BY OTHERS)
- SOFFIT T ANCHOR (104)
- GRIDWORX WEEP MESH (24" O.C.)
- LOW MODULUS SILICONE W/ BACKER ROD

KERF SYSTEM
DATE:
NOTES:
SCALE: 1:1
TITLE:
SHEET: