

**THERMAL BROKEN SUBFRAME**  
WINDOW/DOOR SOFFIT RETURN

ULTRA  
SYSTEM

DATE:

NOTES:

SCALE: 1:1

TITLE:

SHEET:

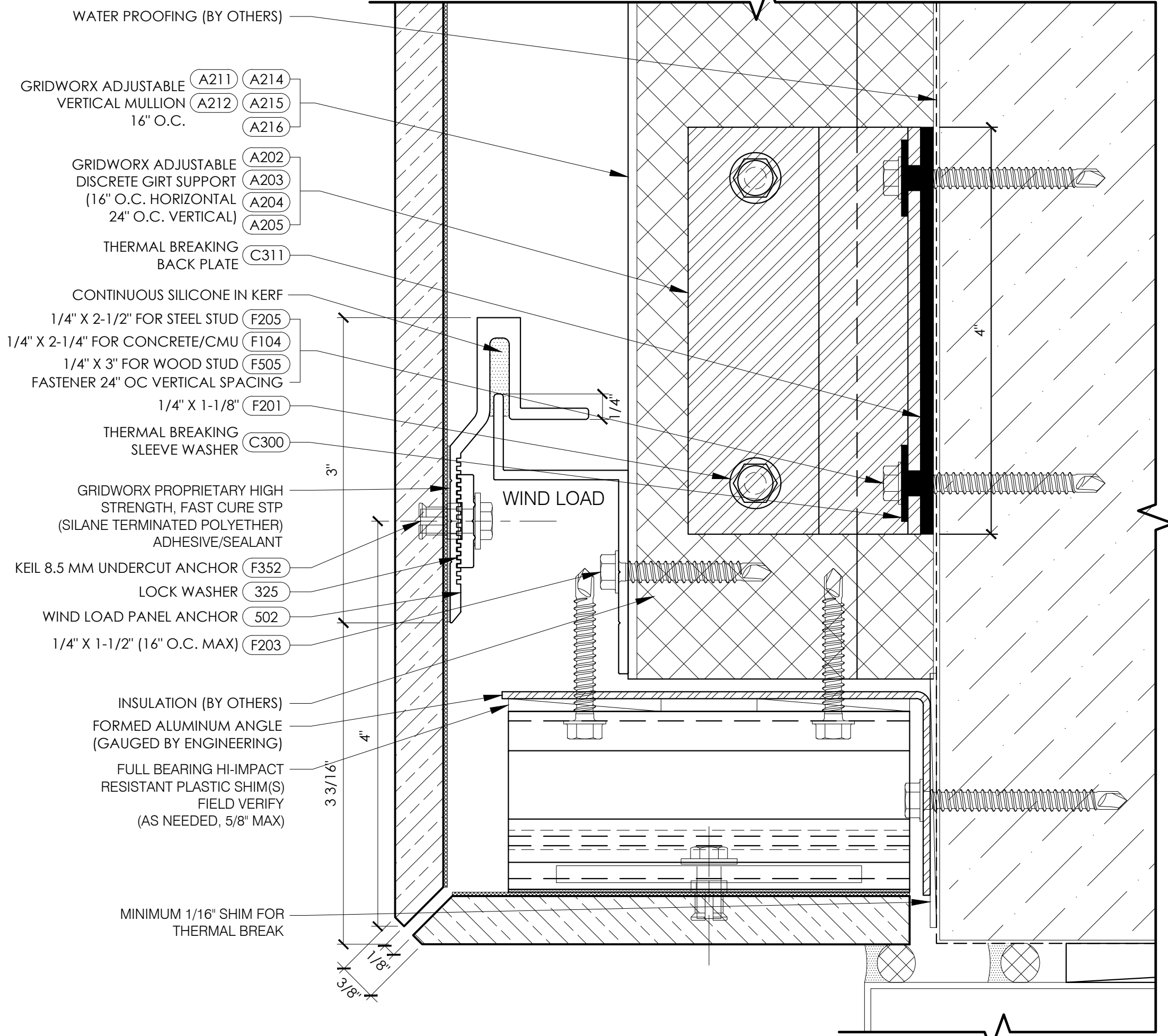

- WATER PROOFING (BY OTHERS)
- GRIDWORX ADJUSTABLE VERTICAL MULLION 16" O.C. (A211, A214, A212, A215, A216)
- GRIDWORX ADJUSTABLE DISCRETE GIRT SUPPORT (16" O.C. HORIZONTAL, 24" O.C. VERTICAL) (A202, A203, A204, A205)
- THERMAL BREAKING BACK PLATE (C311)
- CONTINUOUS SILICONE IN KERF
  - 1/4" X 2-1/2" FOR STEEL STUD (F205)
  - 1/4" X 2-1/4" FOR CONCRETE/CMU (F104)
  - 1/4" X 3" FOR WOOD STUD (F505)
  - FASTENER 24" OC VERTICAL SPACING (F201)
- THERMAL BREAKING SLEEVE WASHER (C300)
- GRIDWORX PROPRIETARY HIGH STRENGTH, FAST CURE STP (SILANE TERMINATED POLYETHER) ADHESIVE/SEALANT
- KEIL 8.5 MM UNDERCUT ANCHOR (F352)
- LOCK WASHER (325)
- WIND LOAD PANEL ANCHOR (502)
- 1/4" X 1-1/2" (16" O.C. MAX) (F203)

- INSULATION (BY OTHERS)
- FORMED ALUMINUM ANGLE (GAUGED BY ENGINEERING)
- FULL BEARING HI-IMPACT RESISTANT PLASTIC SHIM(S) FIELD VERIFY (AS NEEDED, 5/8" MAX)
- MINIMUM 1/16" SHIM FOR THERMAL BREAK